

Canister Mount HD manual



1. Fold the webbing twice. All three parts of the webbing should have the same length. Press hard on the folds.



2. Place the 16mm shrink tube on each hose clamp.



3. Insert the hose clamps in to the webbing.

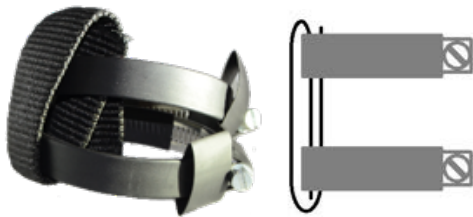

4. Slide the mount onto the canister. Adjust the webbing. Tighten the upper hose clamp. When tightening the clamps, let the ends of clamps go in through the 16 mm shrink tubes.
5. Pull down on the lower hose clamps to tighten the webbing.

